

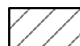



LEGEND

-  10m Buffer line
-  Conservation servitude
-  PARKING
-  Electrical Transformer Room / Sub Station & Generator
-  Wetland
-  Bodycorporate conservation servitude

NOTE

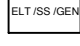
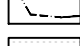
REFUSE REMOVAL:
 The Body Corporate is responsible for the carting of refuse for collection to the off-street Refuse Removal Layby.
 Refuse Storage Rooms are provided on site - as indicated.

YASHAEN LUCKAN ASSOCIATES

PR. ARCH - SACAP NO. 20925
 P.O. BOX 1374, LA MERCY, 4405
 Tel. 031.266.1838
 Cell. 082.044.4324





Client
SURE FOCUS TWENTY TWOcc

**PROPOSED MEDIUM DENSITY HOUSING
 ON ERFS 1/25, 1 TO 10/27 AND REM OF 27, AMANZIMTOTI**

Drawing Scale
1:2.000

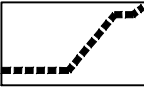
Date
04 December 2017

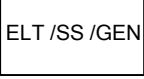
LEGEND

-  10m Buffer line
-  Conservation servitude
-  PARKING
-  Electrical Transformer Room / Sub Station & Generator
-  Wetland
-  Bodycorporate conservation servitude

NOTE

REFUSE REMOVAL:
 The Body Corporate is responsible for the carting of refuse for collection to the off-street Refuse Removal Laybye.
 Refuse Storage Rooms are provided on site - as indicated.

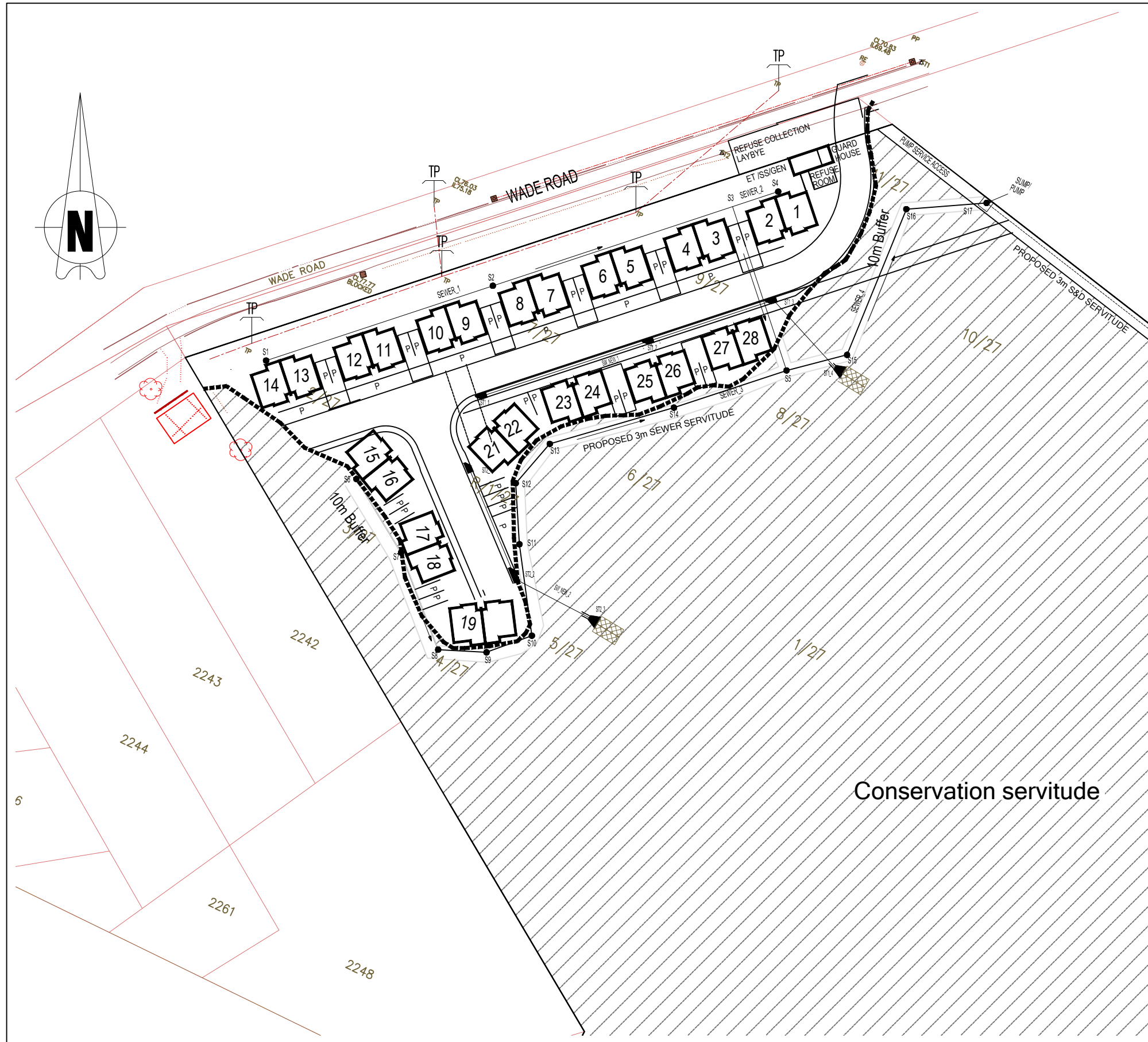

YASHAEN LUCKAN ASSOCIATES

PR. ARCH - SACAP NO. 20925
 P.O. BOX 1374, LA MERCY, 4405

Tel. 031.266.1838
 Cell. 082.044.4324

Client
SURE FOCUS TWENTY TWOcc

**PROPOSED MEDIUM DENSITY HOUSING
 ON ERFS 1/25, 1 TO 10/27 AND REM OF 27, AMANZIMTOTI**

Drawing Scale



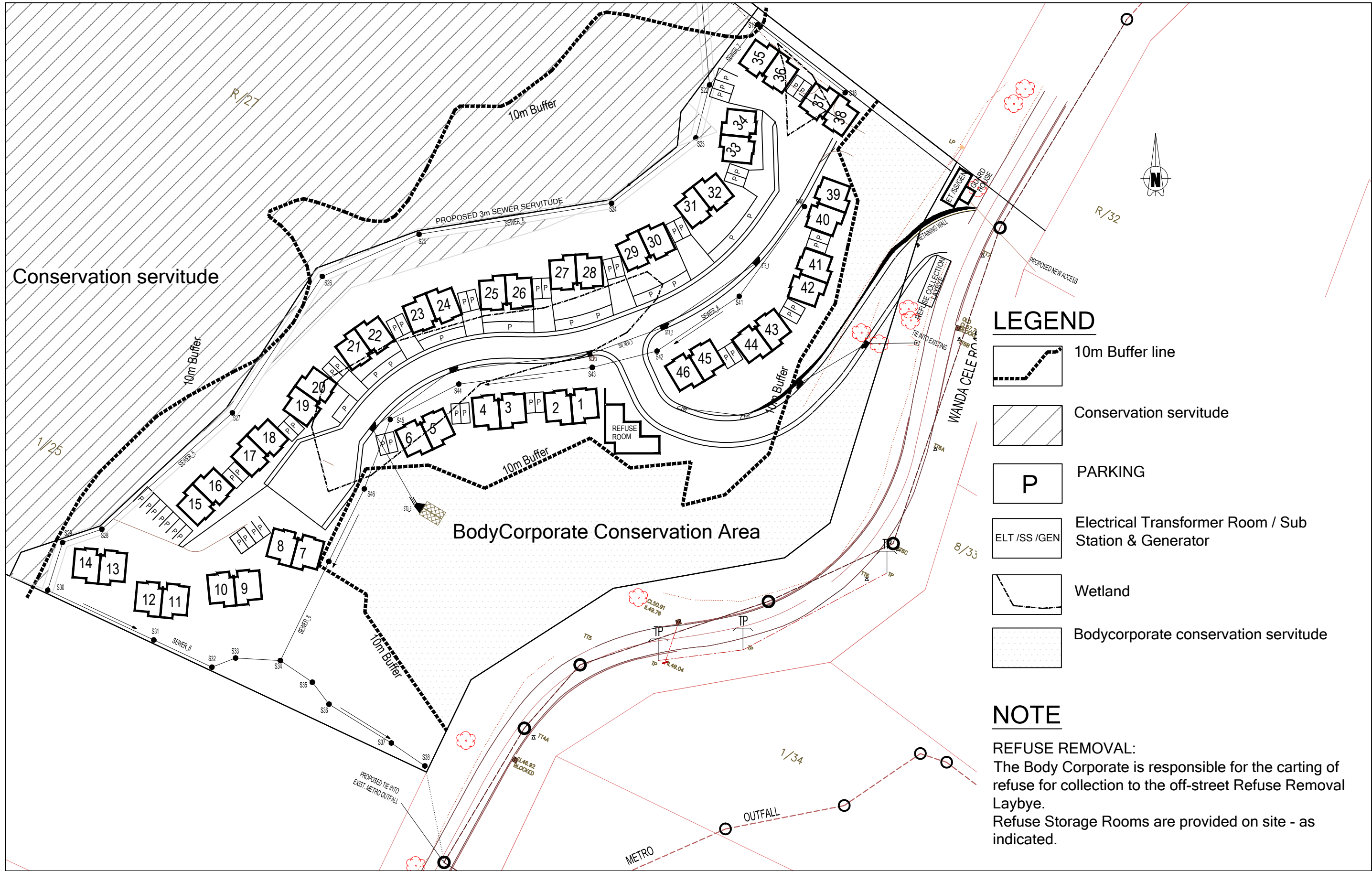

1:1.000

Date

04 December 2017

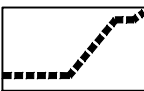
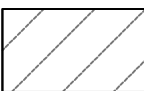

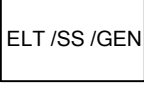
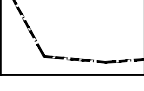
LEGEND

-  10m Buffer line
-  Conservation servitude
-  PARKING
-  Electrical Transformer Room / Sub Station & Generator
-  Wetland
-  Bodycorporate conservation servitude

NOTE

REFUSE REMOVAL:
 The Body Corporate is responsible for the carting of refuse for collection to the off-street Refuse Removal Laybye.
 Refuse Storage Rooms are provided on site - as indicated.

YASHAEN LUCKAN ASSOCIATES

PR. ARCH - SACAP NO. 20925 Tel. 031.266.1838
 P.O.BOX 1374, LA MERCY, 4405 Cell.082.044.4324

Client
SURE FOCUS TWENTY TWOcc

**PROPOSED MEDIUM DENSITY HOUSING
 ON ERF 1/25, 1 TO 10/27 AND REM OF 27, AMANZIMTOTI**

Drawing Scale
1:1.000

Date
04 December 2017